

Part Number: 6278280121

78 RM CORE SET

RM (Rectangular Modulus) cores allow better shielding than E type geometries while also providing easier winding accessibility and better power dissipation than a pot core configuration. Fair-Rite's standard RM cores all have a solid center post and standard height, low profile and alternate materials are available upon request.

RM cores can be supplied with the center post gapped to a mechanical dimension or an  $A_L$  value.

[Catalog Drawing](#)  
[3D Model](#)

Weight indicated is per pair or set.

Weight: 22 (g)

Dim	mm	mm tol	nominal inch	inch misc.
A	27.8	$\pm 0.60$	1.094	—
B	9.3	$\pm 0.15$	0.366	—
C	13.25	$\pm 0.25$	0.522	—
D	6.4	$\pm 0.20$	0.252	—
E	21.65	$\pm 0.45$	0.852	—
F	10.65	$\pm 0.20$	0.419	—
G	12.5	min	0.493	min
J	24.15	$\pm 0.55$	0.951	—

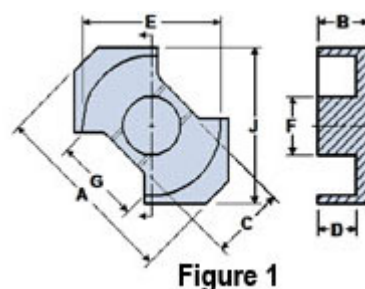



Figure 1

## Chart Legend

$\Sigma l/A$  : Core Constant,  $l_e$  : Effective Path Length,  $A_e$  : Effective Cross-Sectional Area,  $V_e$  : Effective Core Volume

$A_L$  : Inductance Factor 

Explanation of Part Numbers: Digits 1 & 2 = product class and 3 & 4 = material grade.

Electrical Properties	
$A_L$ (nH)	4200 $\pm 25\%$
$A_e$ (cm <sup>2</sup> )	0.898

Electrical Properties	
$\Sigma l/A(\text{cm}^{-1})$	5.3
$l_e(\text{cm})$	4.79
$V_e(\text{cm}^3)$	4.306
$A_{\min}(\text{cm}^2)$	0.884

$A_L$  value is measured at 1 kHz,  $B < 10$  gauss.

Fair-Rite Products Corp. • One Commercial Row, Wallkill, New York 12589-0288  
888-324-7748 • 845-895-2055 • Fax: 845-895-2629 • [ferrites@fair-rite.com](mailto:ferrites@fair-rite.com) • [www.fair-rite.com](http://www.fair-rite.com)